

MFAH CAMPUS PEDESTRIAN TUNNEL LL (Lower Level)

The MFAH comprises five buildings connected by underground tunnels.



FUNDED IN PART BY
THE CITY OF HOUSTON
THROUGH
HOUSTON ARTS ALLIANCE

Visit Guidelines

Welcome! Please review the guidelines below, designed to help you make the most of your experience, while also protecting the art in our care. Museum staff members are ready to answer any questions.



Please help our preservation efforts by remaining at least one foot away from all works of art. Touching is not allowed, because dirt and oils on our skin can damage the art.



Guns, weapons of any kind, and hazardous materials are not permitted.



Handheld cameras and phones may be used to take photos for personal use. However, the following are not allowed, whether indoors or outside: flash photography, tripods, selfie sticks, standing lights, drones, and other related equipment, gear, and add-ons. Formal photo shoots require a permit. Go to mfah.org/visit/tips-for-visiting for more information.



You may carry bags and collapsible umbrellas smaller than 11 x 15 x 6 inches. The Museum also permits soft, front-facing baby carriers and strollers. Large bags, rolling luggage, long umbrellas, wagons, scooters, and ride-on cars/bikes (with push handles or automatic) are not permitted.



Please enjoy food and drink at designated locations such as Cafe Leonelli at MFAH or at the Glassell School of Art, Le Jardinier, and our outdoor spaces. Food is not allowed inside the Museum or in galleries.



Go to mobile.mfah.org to explore the Museum on your mobile device: audio guides, videos, and more! Free Wi-Fi is available on the *MFAH-Guest* network.

The MFAH occasionally photographs or films visitors to the Museum, for archival, documentary, publicity, advertising, or other uses. By visiting the Museum, you grant the MFAH permission to use photographs and/or audiovisual recordings in which you appear, for those purposes.

By visiting the Museum, you agree to abide by all policies at mfah.org/visit.



STREET LEVEL

MFAH

VISITOR MAP

MFAH *The Museum of Fine Arts, Houston*
Susan and Faye S. Sarofim Campus

THE NANCY AND RICH KINDER BUILDING

MODERN AND CONTEMPORARY ART
CAFE LEONELLI AT MFAH
LE JARDINIER AT MFAH

3

- 1 GALLERY 309
HIDDEN HISTORIES
- 2 GALLERIES 310/311
COLOR INTO LIGHT
- 3 GALLERY 312 LINE INTO SPACE
- 4 GALLERY 313 LOVE LANGUAGES
- 5 GALLERY 314 CONTESTED LANDSCAPES

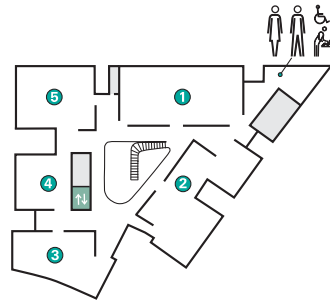

2

- 1 GALLERY 203
EUROPEAN AND AMERICAN ART
- 2 GALLERIES 204/205
LATIN AMERICAN ART
- 3 GALLERY 206
DECORATIVE ARTS, CRAFT, AND DESIGN
- 4 GALLERY 207
WORKS ON PAPER
- 5 GALLERY 208
PHOTOGRAPHY

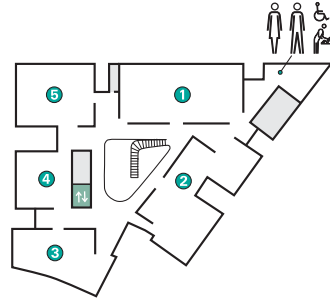

1

- STREET LEVEL
- 1 RESTAURANT La Jardinier at MFAH
 - 2 CAFE Café Leonelli at MFAH
 - 3 GALLERY 100
INSTALLATIONS BY YAYOI KUSAMA, JAMES TURRELL AND GYULA KOSICE
 - 4 GALLERY 101
PERMANENT COLLECTIONS
 - 5 GALLERY 102
MATERIAL AND MOTION

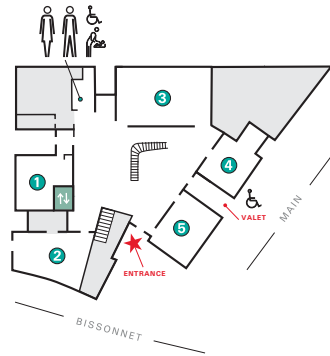

UL

UPPER LEVEL

- 1 LYNN WYATT THEATER
- 2 KINDER GARAGE
UPPER-LEVEL PARKING

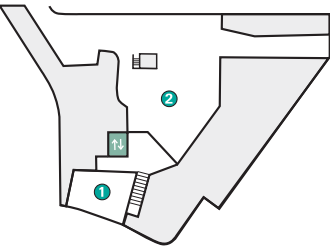

LL

LOWER LEVEL

- 1 FLORES TUNNEL TO LAW BUILDING
INSTALLATION BY CARLOS CRUZ-DIEZ
- 2 LOWER ARRIVAL HALL
INSTALLATION BY EL ANATSUI
- 3 TUNNEL TO GLASSELL BUILDING
TO GLASSELL GARAGE
LOWER-LEVEL PARKING
INSTALLATION BY ÓLAFUR ELÍASSON
- 4 KINDER GARAGE
LOWER-LEVEL PARKING

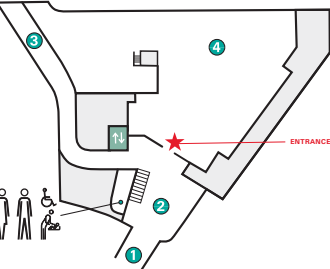

THE CAROLINE WIESS LAW BUILDING

ARTS OF AFRICA, ASIA, THE PACIFIC, AND ISLAMIC WORLDS
INDIGENOUS ARTS OF THE AMERICAS
JUDAICA
SPECIAL EXHIBITIONS
MEMBERS LOUNGE

2

- 1 UPPER BROWN PAVILION
SPECIAL EXHIBITIONS
- 2 ART OF THE INDIGENOUS AMERICAS
- 3 MESOAMERICAN ART
- 4 AFRICAN ART
THE GLASSELL COLLECTIONS
- 5 INDONESIA GOLD
THE GLASSELL COLLECTIONS

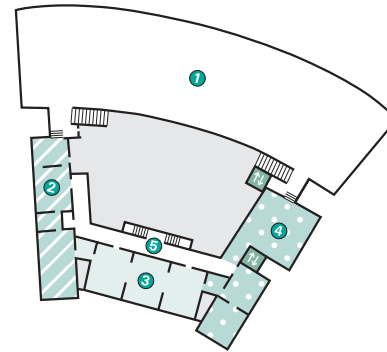

1

- STREET LEVEL
- 1 CULLINAN HALL
SPECIAL EXHIBITIONS
 - 2 ISLAMIC ART FROM THE AL-SABAH COLLECTION
 - 3 HOSSEIN AFSHAR GALLERIES FOR ART OF THE ISLAMIC WORLDS
 - 4 ARTS OF ASIA: KOREA, INDIA, JAPAN, AND CHINA
 - 5 ALBERT AND ETHEL HERZSTEIN GALLERY FOR JUDAICA

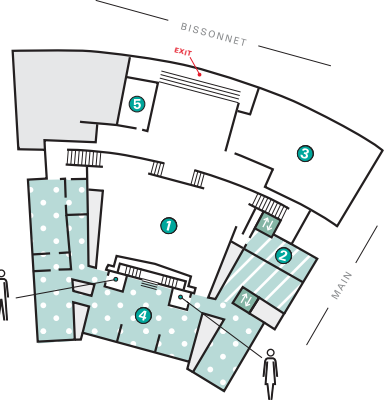

LL

LOWER LEVEL

- 1 WILSON TUNNEL TO BECK BUILDING
INSTALLATION BY JAMES TURRELL
- 2 BROWN AUDITORIUM
- 3 ARTS OF THE PACIFIC
- 4 FLORES TUNNEL TO KINDER BUILDING
INSTALLATION BY CARLOS CRUZ-DIEZ
- 5 LAW CLASSROOM
- 6 MEMBERS LOUNGE

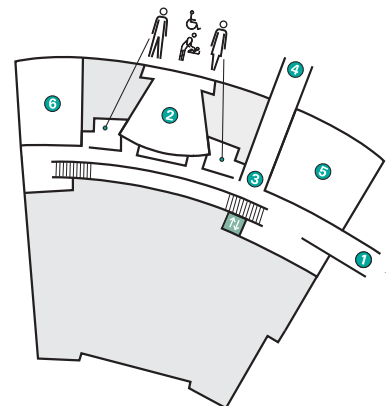

2

- 1 JAMAIL ATRIUM
EGYPTIAN AND MEDITERRANEAN ANTIQUITIES
- 2 EUROPEAN ART 1400-1800
- 3 SPANISH VICEREGAL PAINTINGS FROM THE THOMA COLLECTION
- 4 THE BLAFFER FOUNDATION COLLECTION OF EUROPEAN PAINTING
- 5 EUROPEAN ART 1800-1900
- 6 THE AUDREY JONES BECK COLLECTION OF IMPRESSIONIST AND POST-IMPRESSIONIST PAINTING

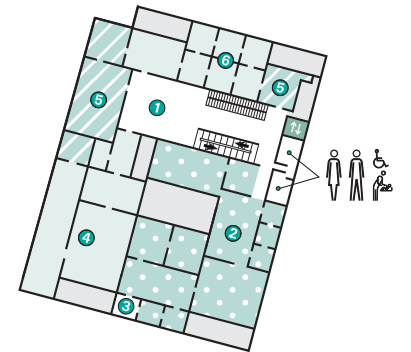

1

- STREET LEVEL
- 1 MFA SHOP
 - 2 CULLEN ATRIUM
GREEK AND ROMAN ANTIQUITIES
 - 3 AMERICAN ART
 - 4 BROWN FOUNDATION, INC., GALLERIES
SPECIAL EXHIBITIONS

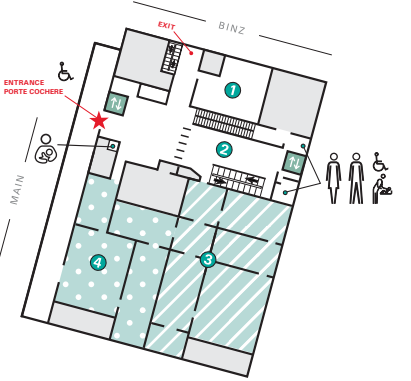

LL

LOWER LEVEL

- 1 WILSON TUNNEL TO LAW BUILDING
INSTALLATION BY JAMES TURRELL
- 2 MILLENNIUM GALLERY
SPECIAL EXHIBITIONS
- 3 PERMANENT COLLECTION EXHIBITIONS
- 4 HIRSCH LIBRARY
- 5 SOUTHWEST BELL STUDIO
- 6 FARISH FUND STUDIO

