

MFAH CAMPUS PEDESTRIAN TUNNEL LL (Lower Level)

The MFAH comprises five buildings connected by an underground tunnel.



FUNDED IN PART BY
THE CITY OF HOUSTON
THROUGH
HOUSTON ARTS ALLIANCE

Visit Guidelines

Welcome! Please review the guidelines below, designed to help you make the most of your experience, while also protecting the art in our care. Museum staff members are ready to answer any questions.



Please help our preservation efforts by remaining at least one foot away from all works of art. Touching is not allowed, because dirt and oils on our skin can damage the art.



Guns, weapons of any kind, and hazardous materials are not permitted.



Handheld cameras and phones may be used to take photos for personal use. However, the following are not allowed, whether indoors or outside: flash photography, tripods, selfie sticks, standing lights, drones, and other related equipment, gear, and add-ons. Formal photo shoots require a permit. Go to mfah.org/visit/tips-for-visiting for more information.



You may carry bags and collapsible umbrellas smaller than 11 x 15 x 6 inches. The Museum also permits soft, front-facing baby carriers and strollers. Large bags, rolling luggage, long umbrellas, wagons, scooters, and ride-on cars/bikes (with push handles or automatic) are not permitted.



Please enjoy food and drink at designated locations such as Cafe Leonelli at MFAH or at the Glassell School of Art, Le Jardinier, and our outdoor spaces. Food is not allowed inside the Museum or in galleries.



Go to mobile.mfah.org to explore the Museum on your mobile device: audio guides, videos, and more! Free Wi-Fi is available on the *MFAH-Guest* network.

The MFAH occasionally photographs or films visitors to the Museum, for archival, documentary, publicity, advertising, or other uses. By visiting the Museum, you grant the MFAH permission to use photographs and/or audiovisual recordings in which you appear, for those purposes.

By visiting the Museum, you agree to abide by all policies at mfah.org/visit.

MFAH

VISITOR MAP



STREET LEVEL

MFAH *The Museum of Fine Arts, Houston*
Susan and Faye S. Sarofim Campus

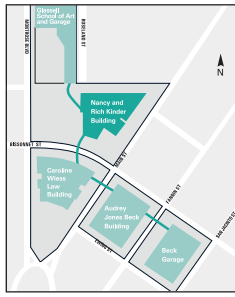

THE NANCY AND RICH KINDER BUILDING

MODERN AND CONTEMPORARY ART
CAFE LEONELLI AT MFAH
LE JARDINIER AT MFAH

3

- GALLERY 309**
BORDER, MAPPING, WITNESS
- GALLERIES 310/311**
COLOR INTO LIGHT
- GALLERY 312** LINE INTO SPACE
- GALLERY 313** LOLI
- GALLERY 314** COLLECTIVITY

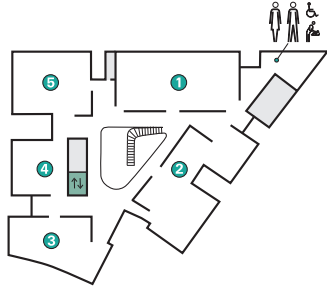

2

- GALLERY 203**
EUROPEAN AND AMERICAN ART
- GALLERIES 204/205**
LATIN AMERICAN ART
- GALLERY 206**
DECORATIVE ARTS, CRAFT, AND DESIGN
- GALLERY 207**
WORKS ON PAPER
- GALLERY 208**
PHOTOGRAPHY

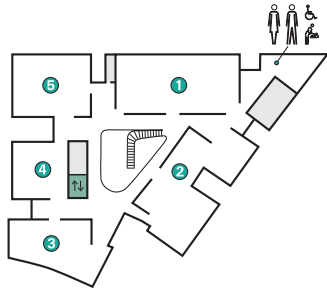

1

- STREET LEVEL
- RESTAURANT** Le Jardinier at MFAH
 - CAFE** Cafe Leonelli at MFAH
 - CULLEN FOUNDATION PROMENADE**
 - HAMILL FOUNDATION PLAZA**
 - GALLERY 100**
INSTALLATIONS BY YAYOI KUSAMA, JAMES TURRELL, AND GYULA KOSICEZ
 - GALLERY 101**
PERMANENT COLLECTIONS
 - GALLERY 102** MATERIALS AND MOTION

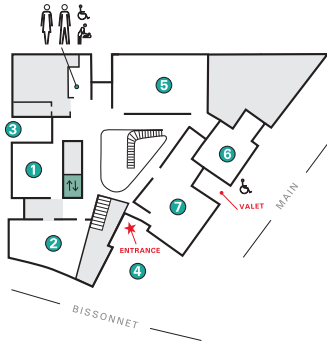

UL

UPPER LEVEL

- LYNN WYATT THEATER**
- KINDER GARAGE**
UPPER-LEVEL PARKING

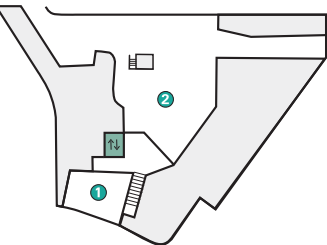

LL

LOWER LEVEL

- FLORES TUNNEL TO LAW BUILDING**
INSTALLATION BY CARLOS CRUZ-DIEZ
- LOWER ARRIVAL HALL**
INSTALLATION BY EL ANATSUI
- TUNNEL TO GLASSELL BUILDING**
TO GLASSELL GARAGE
LOWER-LEVEL PARKING
INSTALLATION BY ÓLAFUR ELÍASSON
- KINDER GARAGE**
LOWER-LEVEL PARKING

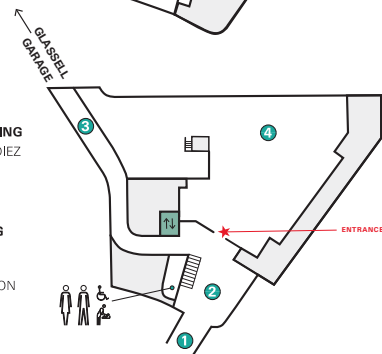

THE CAROLINE WIESS LAW BUILDING

ARTS OF AFRICA, ASIA, THE PACIFIC, AND ISLAMIC WORLDS
INDIGENOUS ARTS OF THE AMERICAS
SPECIAL EXHIBITIONS

2

- UPPER BROWN PAVILION**
SPECIAL EXHIBITIONS
- GOLD OF THE AMERICAS**
THE GLASSELL COLLECTIONS
- MESOAMERICAN ART**
- AFRICAN ART**
THE GLASSELL COLLECTIONS
- INDONESIAN GOLD**
THE GLASSELL COLLECTIONS

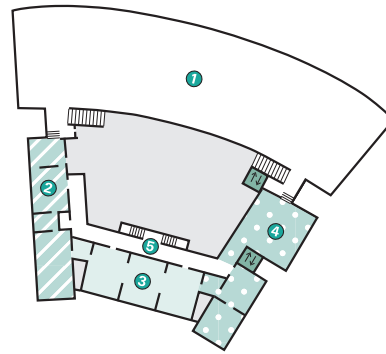

1

- STREET LEVEL
- CULLINAN HALL**
SPECIAL EXHIBITIONS
 - ISLAMIC ART FROM THE AL-SABAH COLLECTION**
 - ART OF THE ISLAMIC WORLDS**
 - ARTS OF ASIA: KOREA, INDIA, JAPAN, AND CHINA**

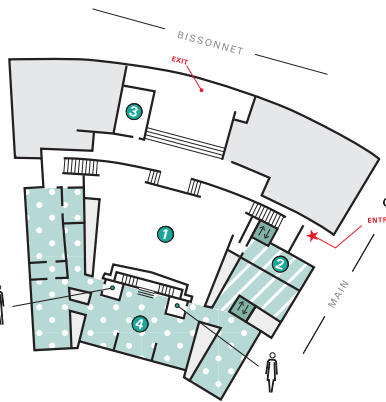

LL

LOWER LEVEL

- WILSON TUNNEL TO BECK BUILDING**
INSTALLATION BY JAMES TURRELL
- BROWN AUDITORIUM**
- ARTS OF THE PACIFIC**
- FLORES TUNNEL TO KINDER BUILDING**
INSTALLATION BY CARLOS CRUZ-DIEZ
- LAW CLASSROOM**
- MEMBERS LOUNGE**

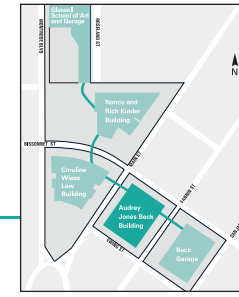
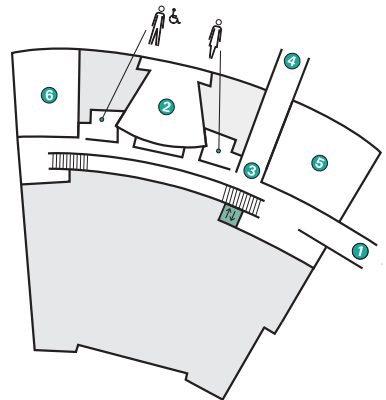

THE AUDREY JONES BECK BUILDING

ARTS OF EUROPE AND THE MEDITERRANEAN
AMERICAN ART UNTIL 1920
SPECIAL EXHIBITIONS
MFA SHOP
HIRSCH LIBRARY

2

- JAMAIL ATRIUM**
EGYPTIAN AND MEDITERRANEAN ANTIQUITIES
- EUROPEAN ART 1400-1800**
- SPANISH VICEREGAL PAINTINGS FROM THE THOMA COLLECTION**
- THE BLAFFER FOUNDATION COLLECTION OF EUROPEAN PAINTING**
- EUROPEAN ART 1800-1900**
- THE AUDREY JONES BECK COLLECTION OF IMPRESSIONIST AND POST-IMPRESSIONIST PAINTING**

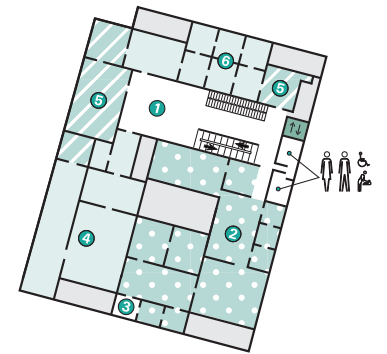

1

- STREET LEVEL
- MFA SHOP**
 - CULLEN ATRIUM**
GREEK AND ROMAN ANTIQUITIES
 - AMERICAN ART**
 - BROWN FOUNDATION, INC., GALLERIES**
SPECIAL EXHIBITIONS

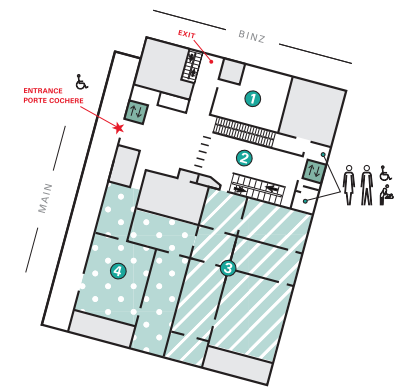

LL

LOWER LEVEL

- WILSON TUNNEL TO LAW BUILDING**
INSTALLATION BY JAMES TURRELL
- MILLENNIUM GALLERY**
SPECIAL EXHIBITIONS
- PERMANENT COLLECTION EXHIBITIONS**
- HIRSCH LIBRARY**

